

Soils Map

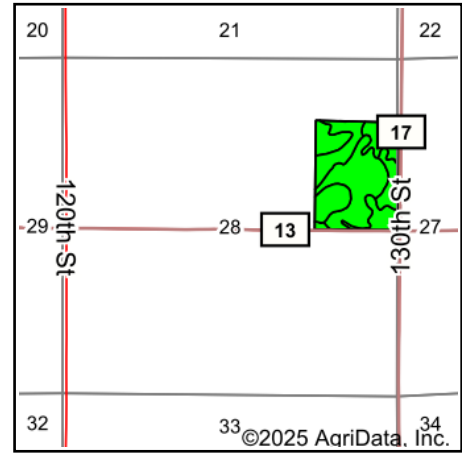

State: **Illinois**
 County: **Mercer**
 Location: **28-15N-4W**
 Township: **Duncan**
 Acres: **53.65**
 Date: **10/15/2025**

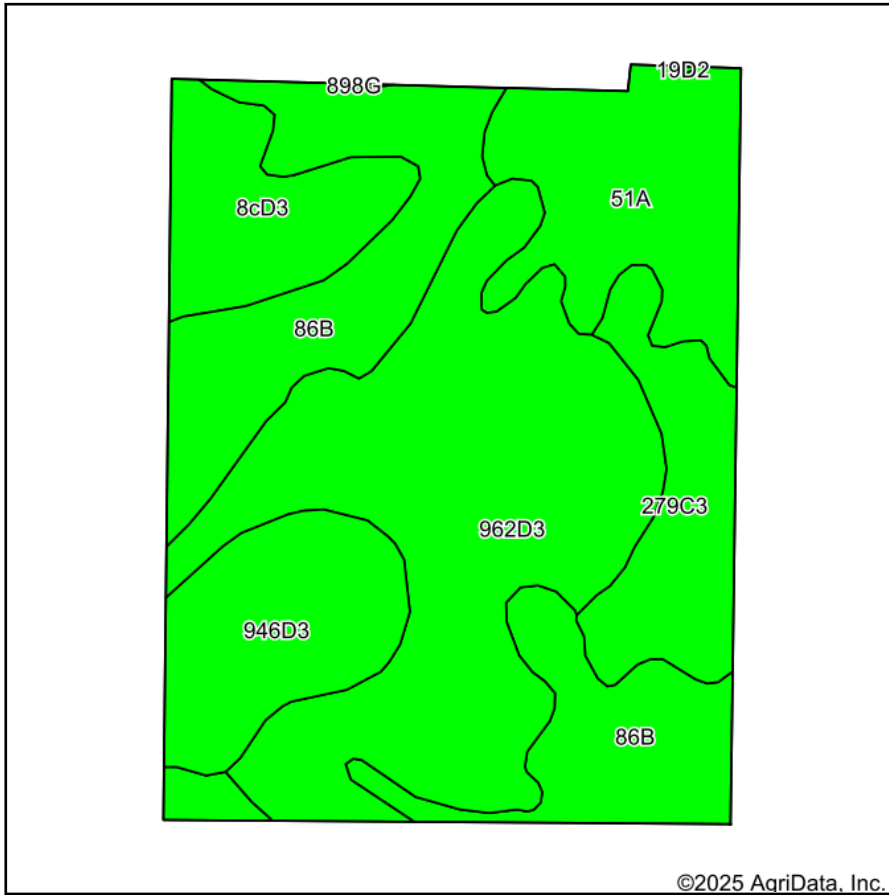

Maps Provided By:



Soils data provided by USDA and NRCS.

©2025 AgriData, Inc.

© AgriData, Inc. 2023

www.AgriDataInc.com

Area Symbol: IL131, Soil Area Version: 20

Code	Soil Description	Acres	Percent of field	Il. State Productivity Index Legend	Restrictive Layer	Soil Drainage	*Subsoil rooting a	*Corn Bu/A	*Soybeans Bu/A	*Wheat Bu/A	*Oats Bu/A b	*Crop productivity index for optimum management	*n NCCPI Overall
**962D3	Sylvan-Bold complex, 10 to 18 percent slopes, severely eroded	18.95	35.4%		> 6.5ft.	Well drained	FAV	**119	**38	**46	**55	**87	64
**86B	Osco silt loam, 2 to 5 percent slopes	12.79	23.8%		> 6.5ft.	Well drained	FAV	**187	**59	**74	**100	**138	92
51A	Muscataune silt loam, 0 to 2 percent slopes	6.99	13.0%		> 6.5ft.	Somewhat poorly drained	FAV	200	64	75	104	147	95
**946D3	Hickory-Atlas complex, 10 to 18 percent slopes, severely eroded	5.63	10.5%		3.2ft. (Densic material)	Well drained	FAV	**86	**30	**34	**39	**66	56

Soils data provided by USDA and NRCS. Soils data provided by University of Illinois at Champaign-Urbana.



Code	Soil Description	Acres	Percent of field	Il. State Productivity Index Legend	Restrictive Layer	Soil Drainage	*Subsoil rooting a	*Corn Bu/A	*Soybeans Bu/A	*Wheat Bu/A	*Oats Bu/A b	*Crop productivity index for optimum management	*n NCCPI Overall
**279C3	Rozetta silty clay loam, 5 to 10 percent slopes, severely eroded	4.77	8.9%		> 6.5ft.	Well drained	FAV	**139	**43	**55	**71	**102	77
**8cD3	Hickory clay loam, cool mesic, 10 to 18 percent slopes, severely eroded	4.52	8.4%		> 6.5ft.	Well drained	FAV	**93	**32	**38	**43	**71	65
Weighted Average								141.9	45.5	55.3	70.8	104.8	*n 75.1

Table: Optimum Crop Productivity Ratings for Illinois Soil EFOTG are sourced from Bulletin 811 calculated Map Unit Base Yield Indices, and adjusted (Adj) for slope, erosion, and surface texture. Publication Date: 01-28-2025

Crop yields and productivity (B811 EFOTG) are maintained at the following USDA web site: 2023 Illinois Soil Productivity and Yield Indices: <https://efotg.sc.egov.usda.gov/#/state/IL/documents/section=2&folder=52809>

* The flood/pond factor has been removed for B811 indexes and yields.

** Base indexes from Bulletin 811 adjusted for slope, erosion, and surface texture according to the Il. Soils EFOTG

b Soils in the southern region were not rated for oats and are shown with a zero "0".

*n: The aggregation method is "Weighted Average using all components"